



42 Belle Vue Terrace, Great Malvern, WR14 4PZ

£825 Per Month

A second floor unfurnished apartment within a Grade II Listed building in the heart of Great Malvern having lovely views over the Priory and across the Severn Vale. The property offers accommodation comprising:- communal reception hall, stairs to second floor, private entrance hall, dining kitchen, sitting room with views, two bedrooms also having the view, bathroom with bath and shower enclosure. The property benefits from gas central heating, bespoke oak framed secondary glazing. Council tax band B. EPC rating C. Holding deposit £190. Deposit £951. Available March 2026.



Flat 2, 42, Belle Vue Terrace, Great Malvern, Worcestershire, WR14 4PZ

Information

TENANT FEES & TENANCY INFORMATION

HOLDING DEPOSIT: A refundable* holding fee equivalent to one week's rent (£190) is payable in advance in order to reserve the property. The holding fee will be deducted from the first month's rent payment. *Conditions apply

DEPOSIT: A deposit of £951 (equivalent 5 weeks rent) will be required as security against damage or arrears of rent.

RENT: £825 Per calendar month.

FURNISHINGS: The property is offered to let unfurnished

RESTRICTIONS: Non-smokers only. Pets not accepted due to Head Lease restrictions.

APPLICATION: You must complete an application form and online referencing form. This must be completed and returned promptly. Photographic ID (passport) and a current proof of address will be required by all applicants

The property will remain on the market until satisfactory referencing has been received from our referencing company.

Allan Morris & Ashton Ltd is a member of Propertymark Client Money Protection Scheme and is also a member of The Property Ombudsman redress scheme. Further information available on the agent's website

Directions

Belle Vue Terrace can be found in the centre of Great Malvern. Opposite the post office The entrance to this apartment is located to the left of the pedestrian crossing and Iapetus Gallery, with the old sign for the Masonic Hall over the doorway.

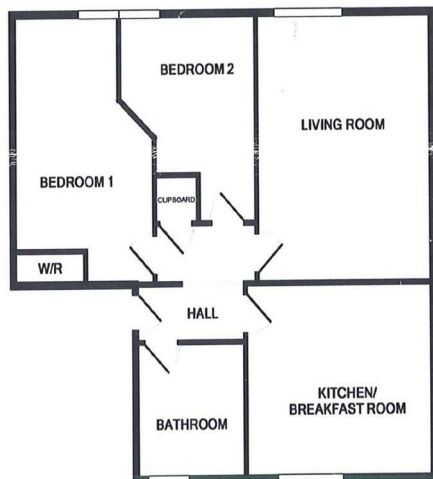

EPC

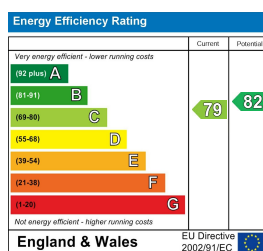

Material Information Report

